



Be Where Aware!

2014 Ohio GIS Conference and Trade Show

September 22-24, 2014

You are invited to exhibit at the 2014 Ohio GIS Conference.

Don't miss this outstanding opportunity to interact with the largest gathering of GIS professionals in Ohio. If your company provides GIS services, products, hardware or software, you need to be here. Register today!

**Complete your registration online at www.ceao.org
or fax/mail/email your registration form to the CEAO office.**

Cost

Exhibit Space

\$600 per display area

Included in your exhibit fee:

- One 8' x 10' display area (or similar size) with 6' L x 2' W x 30" H skirted table and 2 folding chairs
- One 7" x 44" exhibitor ID sign
- Company name listed in the program
- No charge to attend conference sessions for up to two people

Conference Hotel

Hyatt Regency Columbus

350 North High Street
Columbus, OH 43215
(614) 463-1234

Online registration available at <https://resweb.passkey.com/go/GISConference2014>

\$149 single | \$159 double | \$169 triple | \$179 quad

Reserve before September 1, 2014 to receive group rate

Space is limited!

Submit your registration form and payment today to:

County Engineers Association of Ohio

6500 Busch Blvd.

Ste. 100

Columbus, OH 43229-1738

Phone: (614) 221-0707

Fax: (614) 221-5761

E-mail: info@ceao.org

Sponsor This Event

Increase your company's visibility even more by becoming a conference sponsor. We have a variety of sponsorship opportunities available to meet every budget.

See registration form for details.

Trade Show Tentative Schedule

September 22, 2014

Set up 10:00am – 12:00pm

Open 12:00pm – 6:00pm

Reception 4:30pm – 6:00pm

September 23, 2014

Open 8:00am – 5:00pm

Continental Breakfast ... 8:00am – 9:00am

Refreshment Break 9:55am – 10:20am

Refreshment Break 2:10pm – 3:00pm

September 24, 2014

Open 8:00am – 12:00pm

Continental Breakfast 8:00am – 9:00am

Refreshment Break 10:10am – 10:30am

Tear down 12:00pm – 2:00pm

**All breaks and the reception will
take place in the Exhibit Area**



Be Where Aware!

2014 Ohio GIS Conference Trade Show Registration Form **September 22-24, 2014**

Organization: _____

Billing Address: _____ City: _____

State: _____ Zip: _____ Phone: _____ Fax: _____

Contact Person: _____ Email: _____

Two registrations and Wednesday lunches are included in the booth fee. Those attending Trade Show are (please print):

Name _____

Name _____

Title _____ ☐ PE ☐ PS ☐ GISP

Title _____ ☐ PE ☐ PS ☐ GISP

Email _____

Email _____

Will attend conference sessions ☐ Yes ☐ No

Will attend conference sessions ☐ Yes ☐ No

Complimentary URISA membership* ☐ Accept ☐ Decline

Complimentary URISA membership* ☐ Accept ☐ Decline

Please describe the service(s)/product(s) and/or specialization provided by your organization. Also list any company or companies you do not wish to be near.

See attached hotel diagram to request your booth location:

1st Choice: _____

2nd Choice: _____

3rd Choice: _____

Authorizing Signature

Title

Cost: \$600 per display area (Includes two conference registrations)

CEAO is not responsible for damaged, lost or stolen equipment.

Thank you for registering for the 2014 Ohio GIS Conference and Trade Show. After this form has been processed, you will be contacted by CEAO regarding your booth assignment and other details. If you have any questions regarding the Conference or Trade Show, please feel free to contact our office. Exhibitors are welcome to attend conference sessions. **If more than two exhibitors will be attending, please complete the Conference Attendee Registration for additional registrants.**

*The Ohio Chapter of URISA is providing a 2015 membership for each paid full conference registrant. Opting out of the Ohio Chapter of URISA membership will not affect the conference registration cost. Information regarding the benefits of the Ohio Chapter of URISA membership can be found at www.ohurisa.org.

Register online at www.ceao.org OR

Please submit this application and payment to:

County Engineers Association of Ohio

6500 Busch Blvd., Columbus, OH 43229-5761

(614) 221-0707 Fax: (614) 221-5761

info@ceao.org



Be Where Aware!

2014 Ohio GIS Conference September 22-24, 2014 Sponsorship Form

Organization: _____

Billing Street: _____ City: _____

State: _____ Zip: _____ Phone: _____ Fax: _____

Name: _____ Title: _____ ☐ PE ☐ PS ☐ GISP

Email: _____

Thank you for choosing to sponsor the 2014 Ohio GIS Conference. Sponsoring our events is a great way to improve name recognition among important customers. There are four Sponsor Levels for this conference; please see the descriptions below and select your Sponsor Level.

☐ **Platinum: \$1500**

- Slide recognition of firm at opening session
- 1-page flyer insert provided by Vendor in attendee packet
- Sign Recognition at Map Gallery, all breaks and Wednesday lunch
- Sign Recognition at Tuesday Evening Event
- Additional marketing material in the attendee packet (i.e. pen, magnet, mouse pad, etc.)

☐ **Gold: \$1000**

- Slide recognition of firm at opening session
- 1-page flyer insert provided by Vendor in attendee packet
- Sign Recognition at Map Gallery, all breaks and Wednesday Lunch
- Sign Recognition at Tuesday Evening Event

☐ **Silver (Vendor): \$500**

- Slide recognition of firm at opening session
- 1-page flyer insert provided by Vendor in attendee packet
- Sign Recognition at Map Gallery, all breaks and Wednesday Lunch

☐ **Bronze (Vendor): \$250**

- Slide recognition of firm at opening session
- 1-page flyer insert provided by Vendor in attendee packet

Please fax, mail or email this form and payment to:

County Engineers Association of Ohio
6500 Busch Blvd., Suite 100
Columbus, OH 43229
Tel: (614) 221-0707 Fax: (614) 221-5761
info@ceao.org

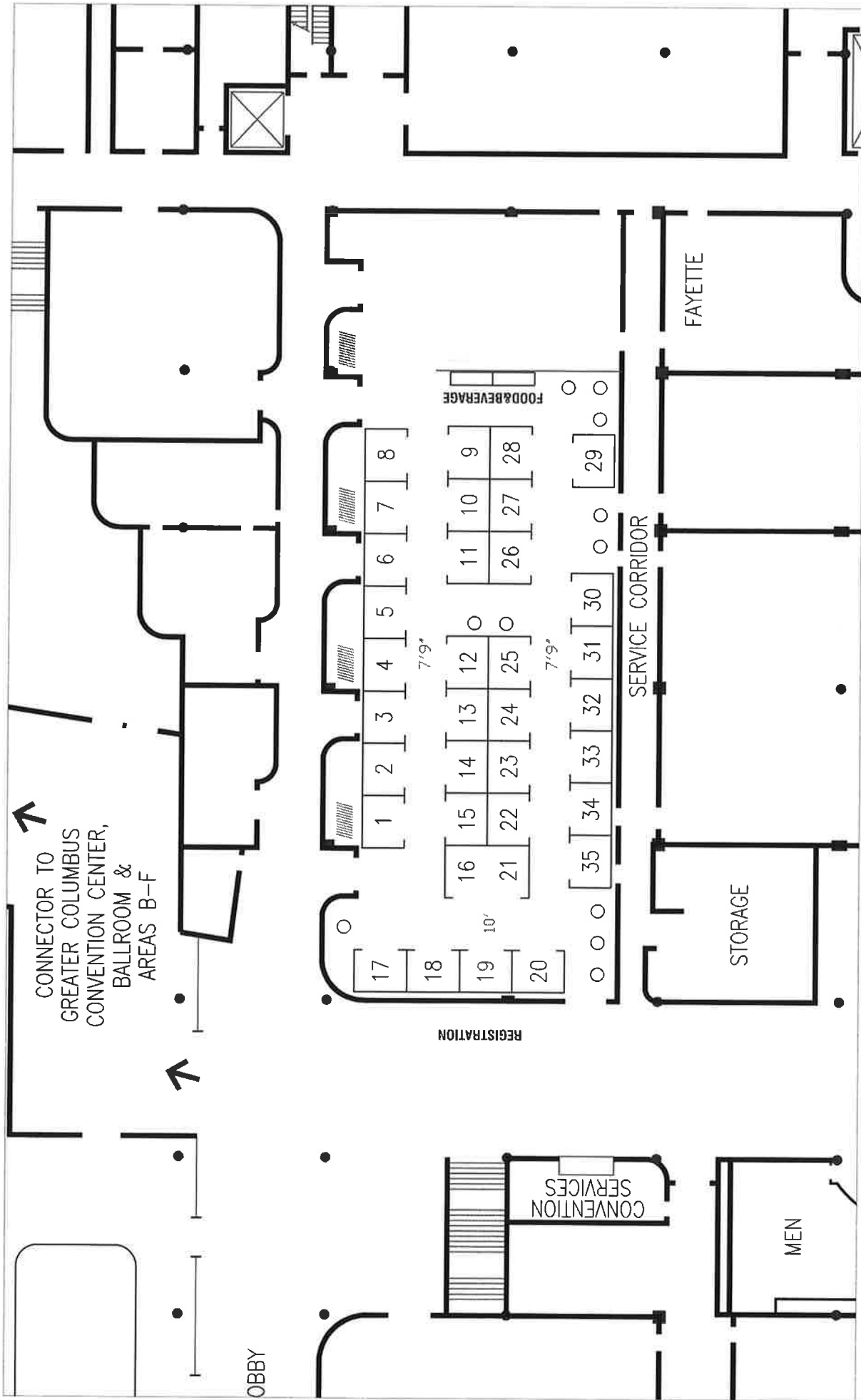

<p>OHIO GIS CONFERENCE SEPTEMBER 22-24, 2014</p> <p>02-03565-14</p> <p>05-20-14</p>	<p>HYATT REGENCY UNION ROOMS</p> <p>JB</p> <p>6'</p>	<p>5000</p> <p>35</p> <p>0</p> <p>8'x10'</p>	<p>35,000</p> <p>2</p> <p>2</p> <p>2</p> <p>2</p>	<p>PREPARED BY GEORGE fern</p> <p>EXPOSITION & EVENT SERVICES 1500 OLD LEONARD AVENUE COLUMBUS, OHIO 43219-2509 TELEPHONE 614-233-1500 FAX 614-233-9101 columbus@fernmapo.com</p>
---	--	--	---	--



Hyatt Regency Columbus Exhibitor AV Order Form

Ohio GIS Conference

Sep 22-24, 2014

Please fill in the grey boxes & return to Kyle Kloetzly at kkloetzly@psav.com. A PSAV representative will confirm your order with a total and confirmation #. Some items may require additional support equipment. Internet access is based on basic bandwidth requirements.

Exhibitor Company Name & Address	Booth # & Location	Order Contact Name, E-mail, & Phone	On-site Contact Name & Cell #	Setup Date/Time	Strike Date/Time				
Quantity	Monitors	Cost per day	Quantity	AV Equipment	Cost per day	Quantity	Internet Support	One-Time Cost	21% Service Charge, Applicable Setup/Strike fees, and OH
	19" Monitor	\$115		Laptop Audio	\$45		Wireless Internet Connection (Basic Access)	\$40/ea	State tax will be added to all orders.
	32" Monitor	\$205		DVD Player	\$75		Wired Internet Line	\$300	
	42" Monitor	\$320		Wireless Slide Advancer	\$45		Dedicated Bandwidth (Call for more info)	Call	
	Monitor Floor Stand	\$75		PC Laptop	\$225		Set/Strike/ Delivery/Pickup Labor @ \$60/Hr		
<p>Credit Card Type: American Express _____ Discover _____ MasterCard _____ Visa _____</p> <p>Credit Card Number: _____ Exp. Date: _____ Security Code: _____</p> <p>Cardholder's Name: _____ Zip Code: _____</p> <p>Cardholder's Billing Address: _____</p> <p>I, (please print) _____, certify the above information to be true and correct to the best of my knowledge. As the cardholder, I am authorizing the above credit card account to be charged for the attached order and any additional amounts incurred as a result of all show site changes ordered by my representatives and/or place my card on file for Security Deposit purposes in the event of payment default, cancellation fees or damages/losses owed per PSAV Terms and Conditions - See Terms and Conditions.</p> <p>Due to equipment availability and labor scheduling requirements, all orders received less than 72 hours in advance of function, may require substitutions or delayed delivery.</p> <p>Signature _____ Date _____</p>									
<p>Subtotal on above items</p> <p>21% Service Charge on above Subtotal</p> <p>Subtotal w/Fees</p> <p>7.5% tax on Subtotal w/Fees</p> <p>TOTAL w/Fees & Tax</p> <p>Return completed form to kkloetzly@psav.com or fax to 614.461.5333. Please contact our office at 614.461.8444 with any questions.</p>									

flawless performance. dramatic results.

